



**Welcome!**

**2017**  
**CCCEPRC**



**Child Care and Early Education  
Policy Research Consortium  
Annual Meeting**

March 1-2, 2017  
The Westin Washington, D.C. City Center  
Washington, D.C.



ADMINISTRATION FOR  
**CHILDREN & FAMILIES**

**OPRE**

**OPRE**

# Meeting Participants

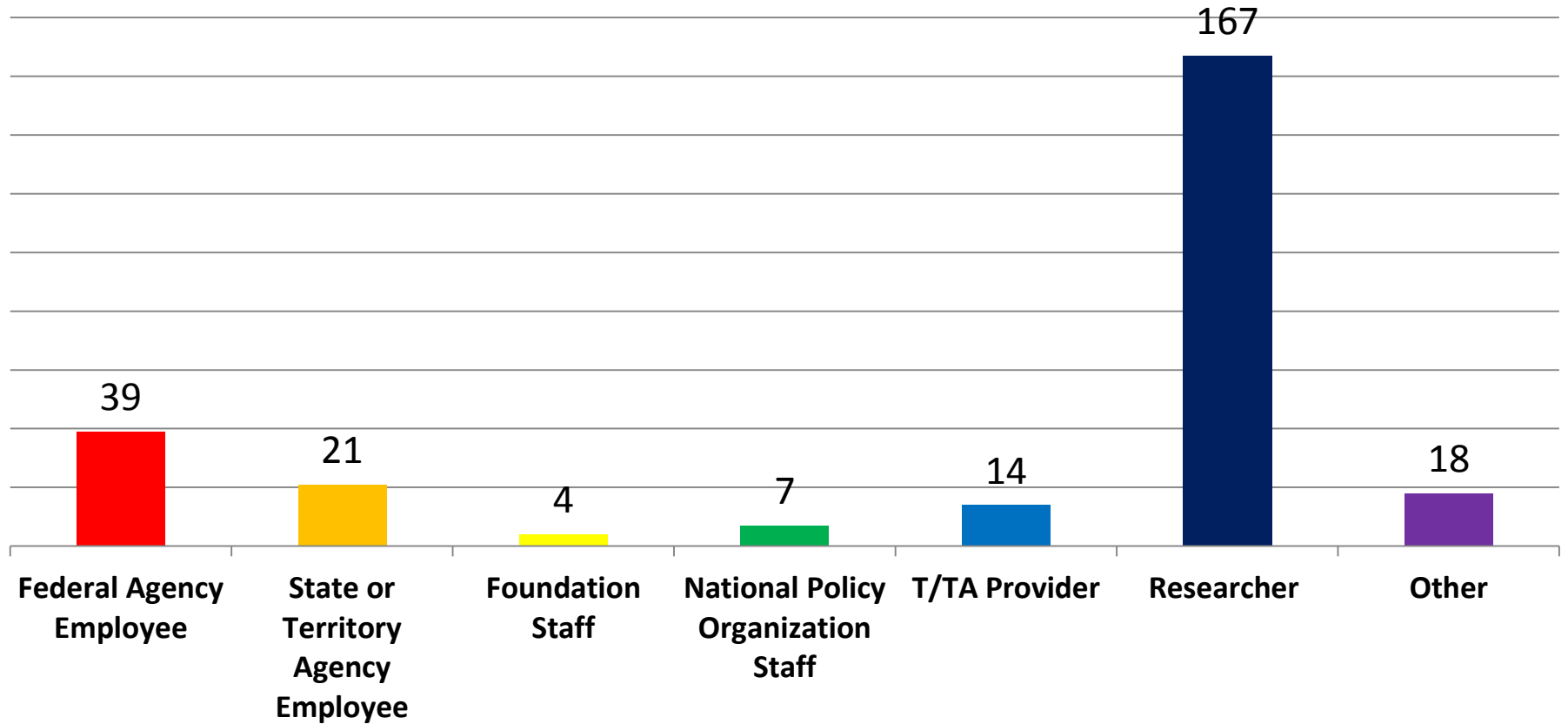

**Wednesday, March 1, 2017**

9:00 a.m. – 9:30 a.m.  
Welcome  
National Ballroom

9:30 a.m. – 10:30 a.m.  
Plenary Session 1: Update on the Implementation of the Head Start Program Performance Standards and Child Care and Development Block Grant Act of 2014  
National Ballroom

10:30 a.m. – 11:00 a.m.  
Break  
Connecting with Colleagues

11:00 a.m. – 12:15 p.m.  
Breakout Sessions A1 – A5

A1: Mapping the Supply and Demand of Child Care and Early Education Programs: Researcher Insights and Evidence-Based Policy Tools To Make Government More Effective  
Ashlawn North

A2: Advances in Providing Multilevel Support for Coaching and Individualized Professional Development  
Ashlawn South

A3: Capacity-Building for State- and Territory-Level Child Care and Development Block Grant Implementation Research and Evaluation  
East Room

A4: Use of Early Care and Education Among Special Populations  
West Room

A5: Innovations in the National Survey of Early Care and Education Data: Local Cost Adjustments, Identification of Subsidy Receipt, and Combinations of Care  
Monticello West

12:15 p.m. – 2:00 p.m.  
Lunch (on Your Own)

12:15 p.m. – 1:45 p.m.  
Early Care and Education Secondary Analysis of Data Grantees Poster Discussion (Grantees Only)  
National Ballroom

2:00 p.m. – 3:00 p.m.  
Plenary Session 2: Transforming the Workforce for Children Birth through Age 8: State Approaches to Increasing Workforce Qualifications  
National Ballroom

3:00 p.m. – 3:15 p.m.  
Break

3:15 p.m. – 4:30 p.m.  
Breakout Sessions B1 – B5

B1: Geographic Information Systems (GIS) and Spatial Methods Workshop Panel: Using GIS and Spatial Analysis To Advance Child Care and Early Education Policy Analysis and Research  
Ashlawn North

B2: Implications for Policy of New Research on the Qualifications and Compensation of the Early Childhood Workforce  
Ashlawn South

B3: Instability in Early Care and Education: Causes, Consequences, and Policy Implications  
East Room

B4: Two-Generation Program Approaches: Strengthening the Research Base for Emerging Programs  
West Room

B5: Implications of New Research and Policy for Quality Rating and Improvement System (QRIS) Design, Implementation, and Evaluation  
Monticello West

4:30 p.m. – 5:00 p.m.  
Break

4:30 p.m. – 5:00 p.m.  
Early Care and Education Secondary Analysis of Data Grantees Poster Viewing  
National Ballroom

5:00 p.m.  
*Adjustment for the Day*

5:00 p.m. – 7:00 p.m.  
CCEEPRC 2017 Meet-and-Greet  
Vista Terrace

**Thursday, March 2, 2017**

9:00 a.m. – 10:00 a.m.  
Plenary Session 3: Research-to-Policy Translation for Generating Evidence-Based Child Care and Early Education Policy  
National Ballroom

10:00 a.m. – 10:15 a.m.  
Break

10:15 a.m. – 11:30 a.m.  
Breakout Sessions C1 – C5

C1: Examining Early Care and Education Use and Access Among Hispanics and Immigrants From Three Complementary Perspectives: National Survey Data, State-Focused Qualitative Data, and State CCDF Policy Analysis  
Ashlawn North

C2: Financing High-Quality Early Care and Education for All Children  
Ashlawn South

C3: Efforts To Increase the Inclusion and Engagement of Young Children with Disabilities in Early Care and Education  
East Room

C4: Improving Quality in Early Childhood Education: What is the Role of Professional Development?  
West Room

C5: Collaboration and Coordination Across the Early Care and Education System  
Monticello West

11:30 a.m. – 11:45 a.m.  
Break

11:45 a.m. – 12:45 p.m.  
Plenary Session 4: Quality Improvement in Home-Based Child Care at the State, Community, and Agency Levels  
National Ballroom

12:45 p.m. – 2:45 p.m.  
Lunch (on Your Own)

1:15 p.m. – 2:30 p.m.  
Affinity Discussions

- Assessing the Implementation and Cost of Early Care and Education  
Ashlawn North
- Child Care Administrative Data Resources and Learning Community  
Ashlawn South
- Demonstration of the User Interface for the Child Care and Development Fund Policies Database  
East Room

- Equity in Access to Early Care and Education  
National Ballroom A
- Key Outcomes of Child and Family Well-being  
National Ballroom B
- Mapping Early Care and Education Access  
National Ballroom A
- Measuring Quality in Home-Based Child Care  
National Ballroom B
- National Survey of Early Care and Education Data Users Group  
West Room
- Preschool Development and Expansion Efforts  
National Ballroom C
- Translating Research to Technical Assistance  
Monticello West

2:45 p.m. – 4:00 p.m.  
Breakout Sessions D1 – D5

D1: Measuring Quality in Home-Based Child Care: Implications for Research  
Ashlawn North

D2: Building More Culturally Responsive and Valid Research: Considering Different Methods With Underrepresented Populations  
Ashlawn South

D3: Access to Early Care and Education: Definitions, Data and Implications for Subsidy Payment Rates  
East Room

D4: Using Technology for the Professional Development of Infant and Toddler Caregivers and Teachers  
West Room

D5: Innovative Methods for Improving Quality in Early Care and Education  
Monticello West

4:00 p.m. – 4:15 p.m.  
Break

4:15 p.m. – 5:15 p.m.  
CCEEPRC 2017 Annual Meeting Reflections and Next Steps for the Field  
National Ballroom

5:15 p.m.  
Adjournment

• Connecting with Colleagues

• CCEEPRC 2017 Meet-and-Greet

• Affinity Discussions

**Pre-Order Your Lunch Today!**

# House Keeping Notes

- Bathrooms
- Meeting rooms
- *Lactation Room available*

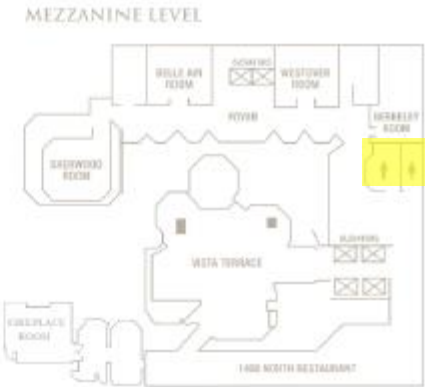
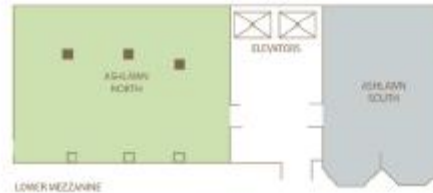

# House Keeping Notes



- Wifi Password: **CCEEPRC2017**  
– *Please limit to 1 device*



- CCEEPRC Logistics Staff



- Meeting Materials available on  
*Research Connections*